

8800 Series 4" Thermal Fixed Human Impact (Psychiatric) Windows

Product Details - Trim - F-Anchor (Fork Anchor) Installation



Note: See Winco Installation Instructions for a detailed description of installation notes and procedures.

WINCO RESERVES THE RIGHT TO MODIFY OR CHANGE INFORMATION WITHIN THIS BOOK WHEN DEEMED NECESSARY FOR PRODUCT IMPROVEMENT

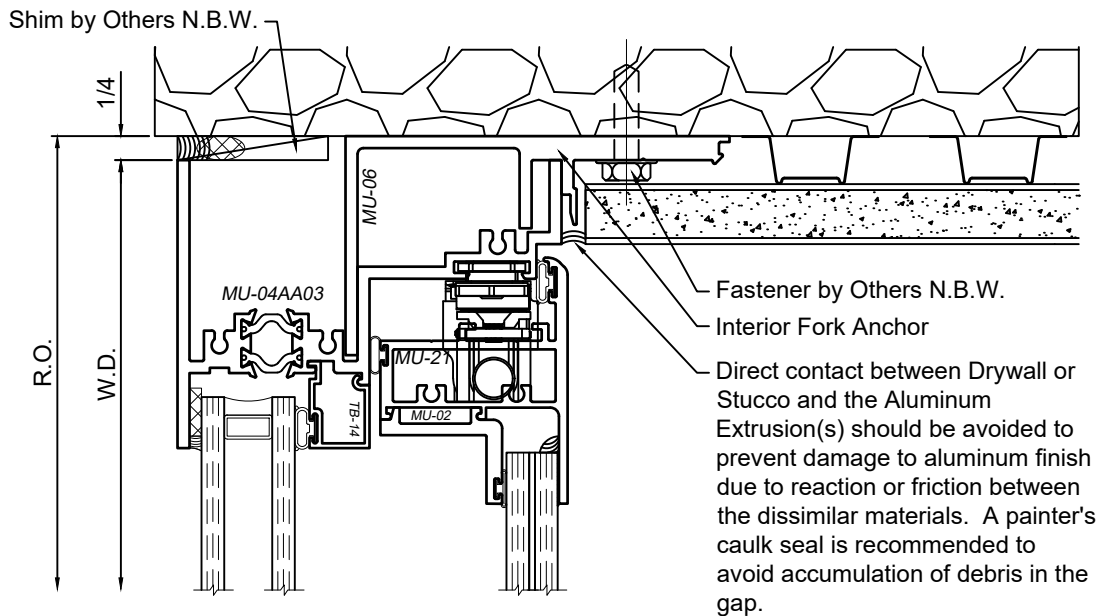
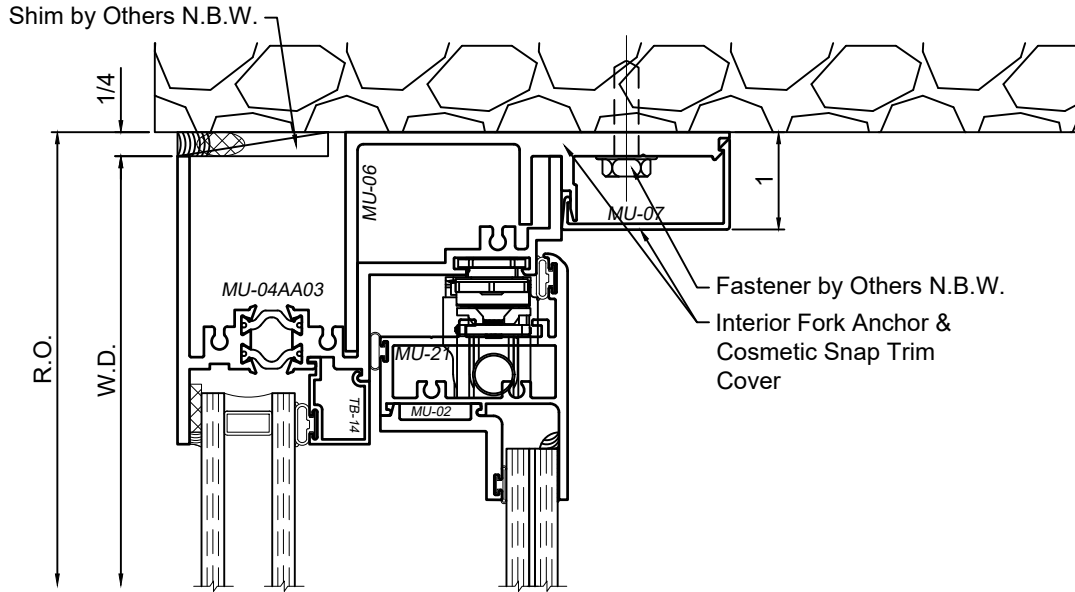

Note:
 This Product System MUST be installed with MU-06 Fork Anchor to meet the tested performance.
 On the exterior side the full range of snap trim trim and pan selection is available for cosmetic purposes.
 A PVC frame filler is not available at this time.

SCALE 6"=1'-0"