



Series 3350

3-1/2" Architectural Grade Thermal Window System
Fixed - Projected - Casement



Product Overview

The 3350 Series Window, with its 3-1/2" deep, 1/8" thick frame and flush vent, makes it a great choice for large window openings and multiple glazing options.

It has been successfully used in many schools, hospitals, blast and hurricane applications for both public and private projects. It is available in fixed, casement, and vent operations either in-swing or out-swing. The window can be manufactured into many configurations to meet your project-specific needs.

As with most Winco Window's between the glass Venetian blinds can be added for total vision control. Also available is a full line of trim and accessories that can take a standard window and turn it into a custom design.

GREEN COMMITMENT

HISTORIC REPLICATION

ENERGY SAVINGS

NOISE CONTROL

BLAST SHIELD

WIND PROTECTION

Features & Custom Options

- Azon "Azo-Brader" thermally broken frame and sash, backed by a 10 year warranty against thermal break shrinkage
- Vertical and horizontal stacking members
- Various glazing thicknesses available
- Dual and triple glazing with optional integral blinds providing dynamic light control
- Wide variety of locking and operating hardware available
- Ability to make inside and outside glazed panels within the same mainframe
- Accessory line of receptors, mullions, panning and trim for a customized look
- Blast, ballistic and impact glazing available
- Optional aluminum extruded screens

Performance Data*

Type	Air (CFM/FT2 @ 6.24 PSF)	Water (PSF)	Structural (PSF)	U-Value (Btu/Hr-Ft ² -°F)	STC
Projected AW Grade AP-AW120	Less than 0.10	12 (Higher levels may be available upon request)	+/- 180	0.41*	Contact your local Rep
Casement AW Grade C-AW-120	Less than 0.10	12 (Higher levels may be available upon request)	+/- 180	0.41*	

*U-Value, CRF, Water and AW ratings are based on a particular type of glazing and window configuration being used. They are provided for comparison purposes only. They are based on products of standard configuration, tested in accordance with NFRC/FGIA/AAMA specifications, in a laboratory environment under optimum conditions. Performance values will vary according to project specifications, installation, size, configuration, hardware, glass, etc. Any required field testing should be done in accordance with the project specifications and FGIA/AAMA field testing protocol, not this data.



Series 3350 Detail Drawings

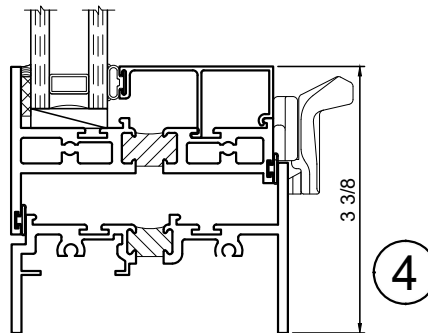
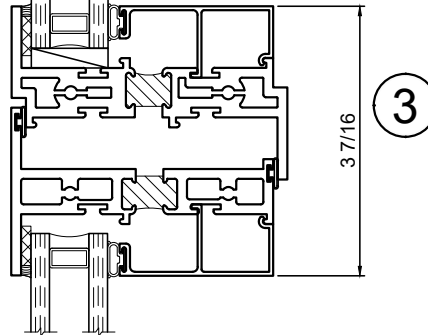
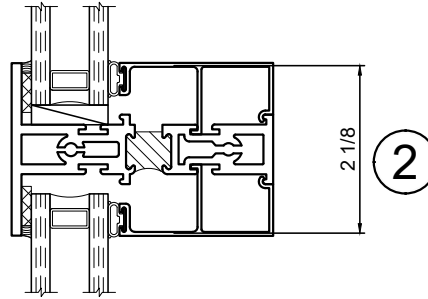
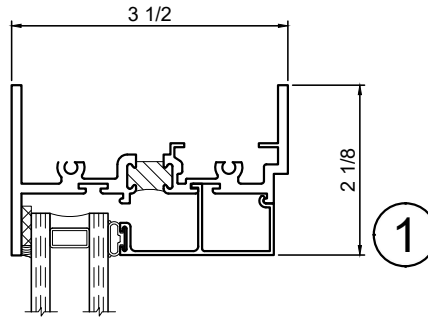
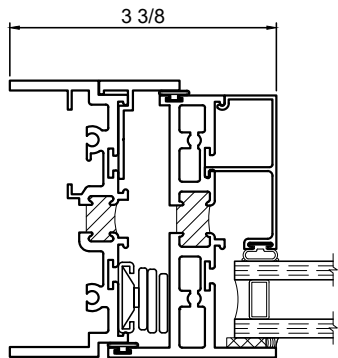
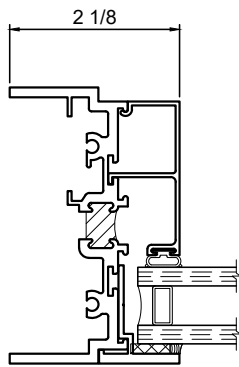
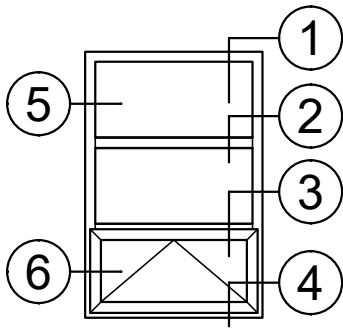

Winco Window Company
6200 Maple Avenue
St Louis, MO 63130

TESTING: Our products meet stringent testing requirements of both the American Architectural Manufacturers Association (AAMA) and the National Fenestration Rating Council (NFRC) standards and certification.

VER:131021

