



Series 3600

3-1/4" Architectural Grade Window System
Fixed - Sliding



Product Overview

The 3600 Series has been successfully used in many applications such as schools, hospitals and condominiums for both public and private developments. Because it provides years of low maintenance performance at a competitive price, the 3600 Slider is frequently specified for new construction projects.

GREEN COMMITMENT

HISTORIC REPLICATION

NOISE CONTROL

Features & Custom Options

- Azon "Azo-Brader" thermally broken frame and sash, backed by a 10 year warranty against thermal break shrinkage
- Accessory line of receptors, mullions, panning and trim for a customized look
- Optional aluminum extruded screens
- Stainless steel roller track cover
- Accompanying fixed frame options include vertical and horizontal stacking members, allowing it to be used as unitized storefront
- Dual glazing with optional integral blinds providing dynamic light control

Performance Data*

Type	Air (CFM/FT2 @ 6.24 PSF)	Water (PSF)	Structural (PSF)	U-Value (Btu/Hr-Ft ² -°F)	STC
Sliding AW Grade S-AW50	Less than 0.10	12 (Higher levels may be available upon request)	+/- 75	0.34*	Contact your local Rep

*U-Value, CRF, Water and AW ratings are based on a particular type of glazing and window configuration being used. They are provided for comparison purposes only. They are based on products of standard configuration, tested in accordance with NFRC/FGIA/AAMA specifications, in a laboratory environment under optimum conditions. Performance values will vary according to project specifications, installation, size, configuration, hardware, glass, etc. Any required field testing should be done in accordance with the project specifications and FGIA/AAMA field testing protocol, not this data.



Series 3600 Detail Drawings

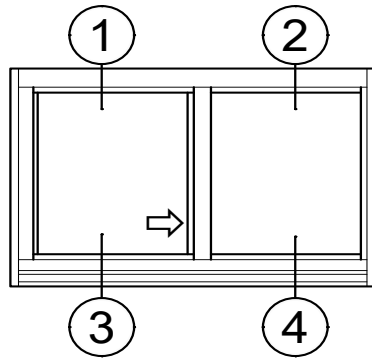

Xo Slider shown
oX Opposite Hand

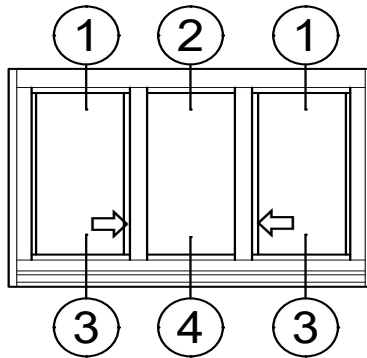

XoX Slider

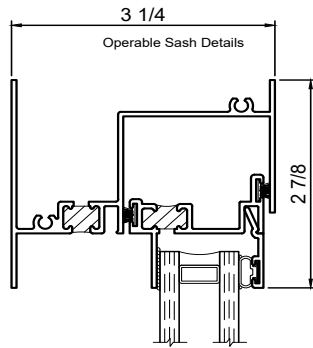

1

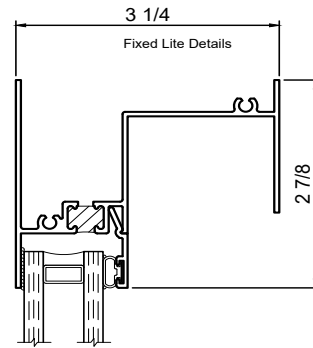

2

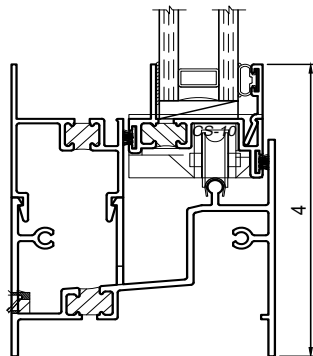

3

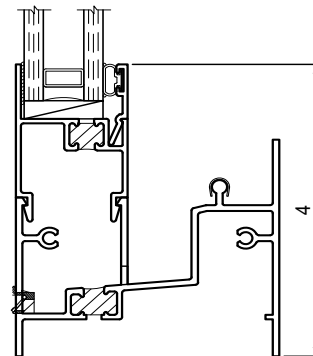

4



Winco Window Company
6200 Maple Avenue
St Louis, MO 63130

TESTING: Our products meet stringent testing requirements of both the American Architectural Manufacturers Association (AAMA) and the National Fenestration Rating Council (NFRC) standards and certification.

VER:131021

