



# Series 3600 Ribbon Window Configuration

3-1/4" Architectural Grade Thermal Window System  
Fixed



## Product Overview

The 3600 Series is a sliding, fixed, and unitized storefront window system configuration that will provide years of low maintenance performance at a competitive price. With an optional integrated glazing bead and trim combination, the fixed 3600 is an efficient, pre-glazed installation upgrade for traditional storefront openings.

GREEN COMMITMENT

HISTORIC REPLICATION

NOISE CONTROL

WIND PROTECTION

## Features & Custom Options

- Azon "Azo-Brader" thermally broken frame and sash, backed by a 10 year warranty against thermal break shrinkage
- Can result in contemporary storefront window style aesthetic
- 3 1/4" frame depth 0.062" wall thickness for superior structural performance and durability
- Full depth glazing bead for the flush glazed appearance
- Slim profile horizontal and vertical rails
- Glazing up to 1" thick insulated units
- Male/ female legs for unitized stacking horizontally or vertically
- Ideal for project that demands a quick and simple installation
- Optional reinforcing for higher design loads
- Optional accessory line of subframes and trim for a customized look

## Performance Data\*

Type	Air (CFM/FT2 @ 6.24 PSF)	Water (PSF)	Structural (PSF)	STC
Fixed AW Grade AW-80	Less than 0.10	12 (Higher levels may be available upon request)	+/- 120	Contact your local Rep

\*U-Value, CRF, Water and AW ratings are based on a particular type of glazing and window configuration being used. They are provided for comparison purposes only. They are based on products of standard configuration, tested in accordance with NFRC/FGIA/AAMA specifications, in a laboratory environment under optimum conditions. Performance values will vary according to project specifications, installation, size, configuration, hardware, glass, etc. Any required field testing should be done in accordance with the project specifications and FGIA/AAMA field testing protocol, not this data.



# Series 3600 Deep Bead Detail Drawings

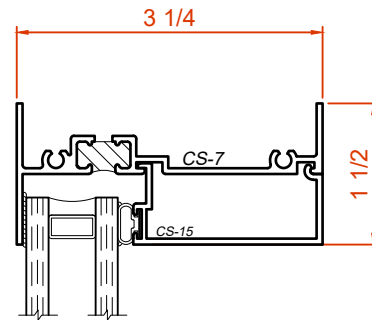
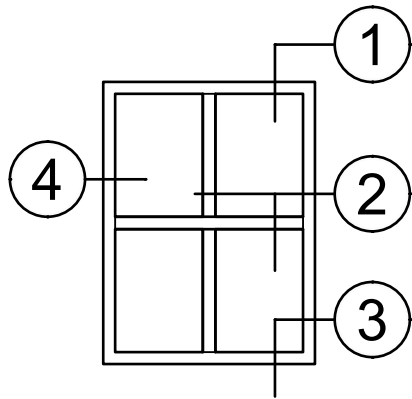

1

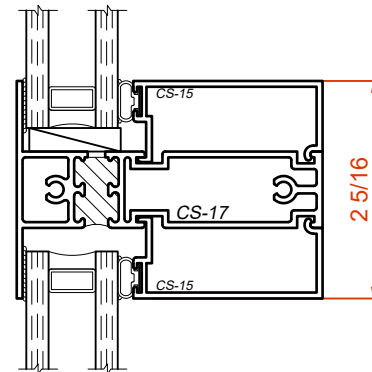

2

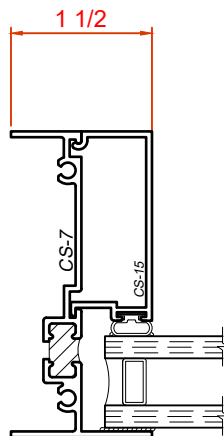

4

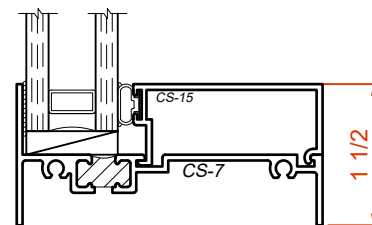

3



Winco Window Company  
6200 Maple Avenue  
St Louis, MO 63130

TESTING: Our products meet stringent testing requirements of both the American Architectural Manufacturers Association (AAMA) and the National Fenestration Rating Council (NFRC) standards and certification.

VER:260625