



Series 3325SF Zero Sightline Storefront

3-1/4" Architectural Grade Window System
Projected - Casement



Product Overview

Transform your storefront window system with the 3325SF Zero Sightline Window Vent, designed to enhance both aesthetics and functionality. This innovative operable window vent system features a nearly invisible profile that seamlessly integrates into your building's facade, ensuring uninterrupted sightlines while promoting natural airflow for enhanced occupant comfort.

Available as a project-out or outswing casement window, with options for a roto operator, the 3325SF series comes prefabricated and pre-glazed, complete with a convenient 1" glazing pocket insert for easy installation. Perfect for new constructions or retrofitting projects, this window vent is the ultimate choice for maximizing visual appeal and occupant satisfaction.

HISTORIC REPLICATION

ENERGY SAVINGS

NOISE CONTROL

GREEN COMMITMENT

Features & Custom Options

- Azon "Azo-Brader" thermally broken frame backed by a 10 year warranty against thermal break shrinkage
- A fully mitered overlap sash configuration has 1/8" wall thickness with fully sealed corners and dual weather-stripping
- Factory glazed with 1" glass and 3M VHB structural glazing tape
- Wide variety of locking and operating hardware available
- Optional aluminum extruded screens
- Optional blast glazed

Performance Data*

Type	Air (CFM/FT2 @ 6.24 PSF)	Water (PSF)	Structural (PSF)	CRF	U-Value (Btu/Hr-Ft ² -°F)	STC
Projected AW Grade AP-AW80	Less than 0.10	12 (Higher levels may be available upon request)	+/- 120	63*	0.36*	Contact your local Rep
Casement AW Grade C-AW80	Less than 0.10	12 (Higher levels may be available upon request)	+/- 120	63*	0.36*	

*U-Value, CRF, Water and AW ratings are based on a particular type of glazing and window configuration being used. They are provided for comparison purposes only. They are based on products of standard configuration, tested in accordance with NFRC/FGIA/AAMA specifications, in a laboratory environment under optimum conditions. Performance values will vary according to project specifications, installation, size, configuration, hardware, glass, etc. Any required field testing should be done in accordance with the project specifications and FGIA/AAMA field testing protocol, not this data.

Series 3325SF Zero Sightline Detail Drawings

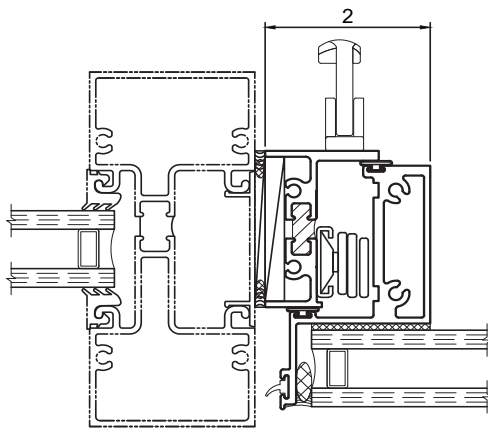
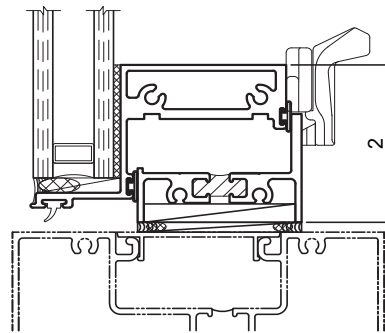
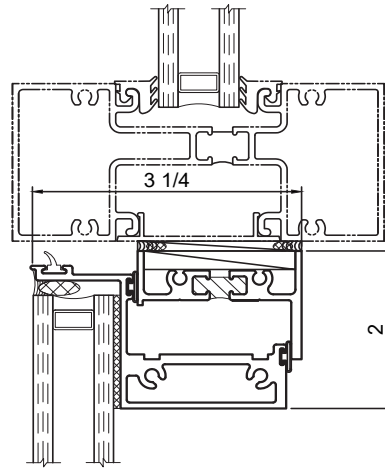
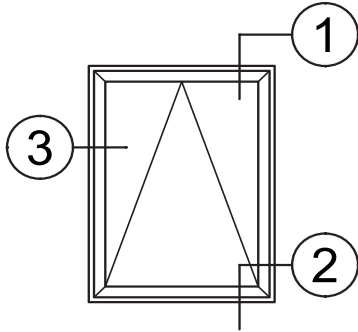

3

2



Winco Window Company
6200 Maple Avenue
St Louis, MO 63130

TESTING: Our products meet stringent testing requirements of both the American Architectural Manufacturers Association (AAMA) and the National Fenestration Rating Council (NFRC) standards and certification.

VER:290925