

# 8800 Series 4" Thermal Fixed Human Impact Windows

## Product Details - Trim - F-Anchor (Fork Anchor) Installation



Note: See Winco Installation Instructions for a detailed description of installation notes and procedures.

The Fork Anchor MU-06 is mandatory to yield impact resistance to AAMA 501.8. The Snap On cover MU-07 is optional. The Anti-Ligature Guard Bar-10 is optional and only furnished when NYSOMH Anti-Ligature configuration is specified.

WINCO RESERVES THE RIGHT TO MODIFY OR CHANGE INFORMATION WITHIN THIS BOOK WHEN DEEMED NECESSARY FOR PRODUCT IMPROVEMENT

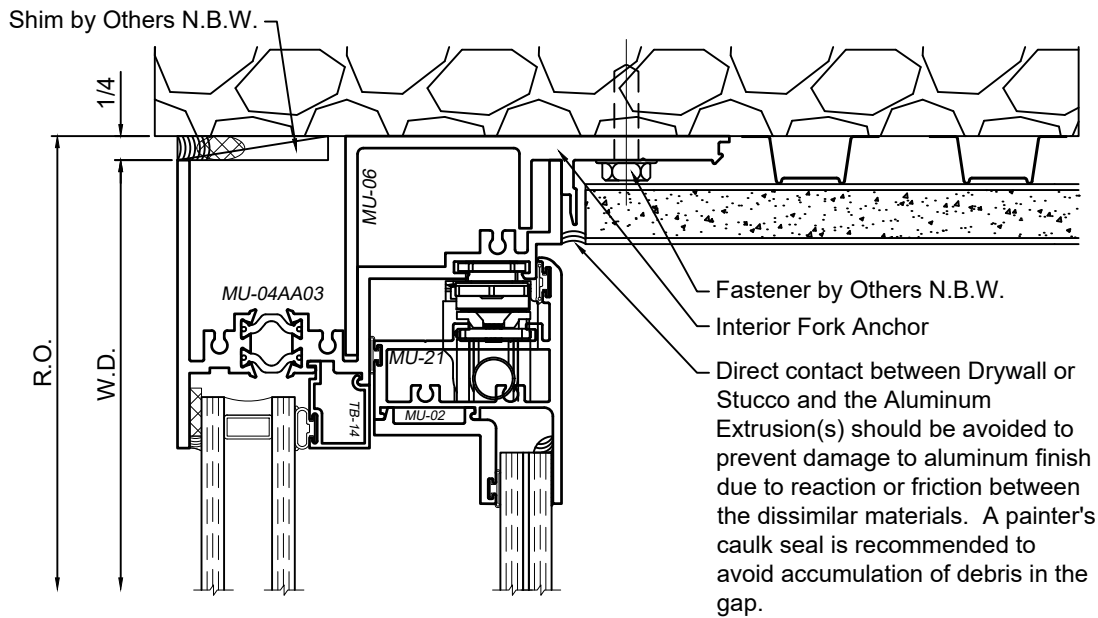
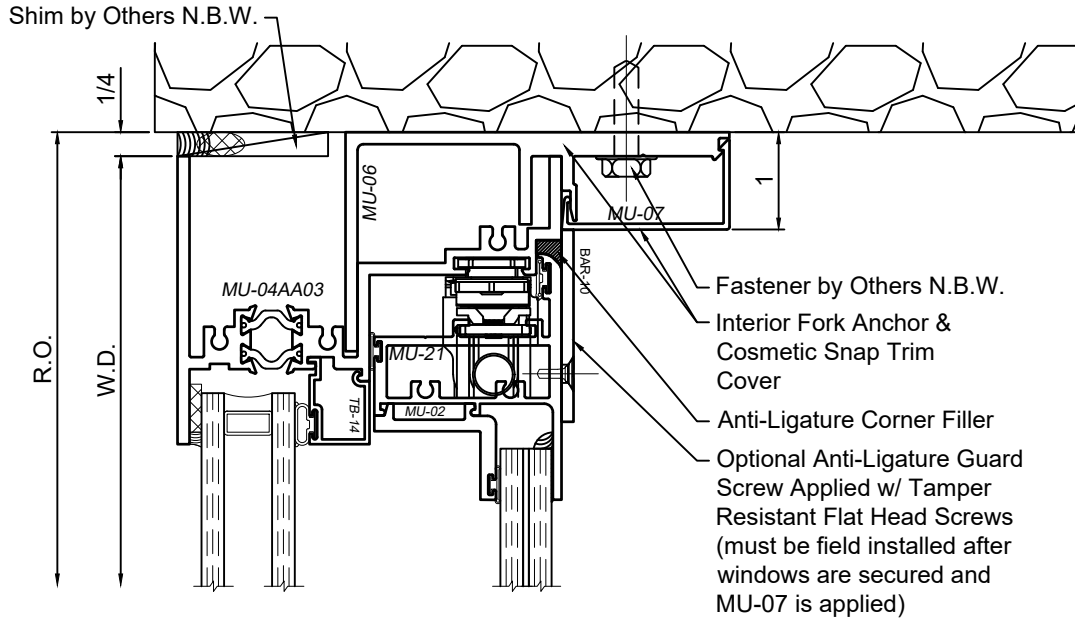

Note:  
 This Product System MUST be installed with MU-06 Fork Anchor to meet the tested performance.  
 On the exterior side the full range of snap trim trim and pan selection is available for cosmetic purposes.  
 A PVC frame filler is not available at this time.

SCALE 6"=1'-0"